

# CH and MH - MA for aggressive environments E-Xtreme®

inserts		page:
CD	64 poles + ⊕	72
CDD	108 poles + ⊕	81
CDS	42 poles + ⊕	-
CDSH	42 poles + ⊕	89
CNE	24 poles + ⊕	113
CSE	24 poles + ⊕	-
CSH	24 poles + ⊕	113
CSH S	24 poles + ⊕	125
CCE	24 poles + ⊕	133
CMSH	10+2 (aux) poles + ⊕	140
CMCE	10+2 (aux) poles + ⊕	141
CSS	24 poles + ⊕	151
CT, CTS (10A *)	64 poles + ⊕	157
CT, CTSE (16A *)	24 poles + ⊕	163
CQE	46 poles + ⊕	171
CQEE	64 poles + ⊕	177
CX	4/8 and 6/6 poles + ⊕	204 and 206
MIXO	6 modules	262 - 317

\*) only for enclosure CHIE 24

## housings with 2 levers and cover



**2.000 HOURS**

## hoods with riveted locking pegs and cover



**2.000 HOURS**

description	part No.	part No	entry M	part No.	entry M
bulkhead mounting housing, with levers and gasket	<b>CHIE 24</b>				
surface mounting housing, with levers, high construction		<b>MAPE 24.32</b>	32		
cover with 4 pegs (for enclosures with 2 levers) <sup>1)</sup>	<b>CHCE 24</b>				
with pegs, side entry				<b>MHOE 24.25</b>	25
with pegs, side entry				<b>MHOE 24.32</b>	32
with pegs, side entry, high construction				<b>MAOE 24.32</b>	32
with pegs, side entry, high construction				<b>MAOE 24.40</b>	40
with pegs, top entry				<b>MHVE 24.25</b>	25
with pegs, top entry				<b>MHVE 24.32</b>	32
with pegs, top entry, high construction				<b>MAVE 24.32</b>	32
with pegs, top entry, high construction				<b>MAVE 24.40</b>	40
cover with 2 levers (for enclosures with 4 pegs) <sup>2)</sup>				<b>CHCE 24 G</b>	
with levers and gasket, top entry, high construction				<b>MAVE 24 G32</b>	32

- 2.000 hours in salt spray tests (EN ISO 9227)  
 - temperature limits: -40 °C ... +125 °C  
 - mechanical life: ≥ 500 cycles  
 Alternatively, hoods with pegs are coupled with fixed enclosures:  
 - C7 E-Xtreme®, IP66/IP67 stainless steel lever, page 536

### CHIE

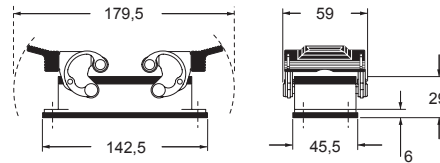

panel cut-out for bulkhead mounting housings

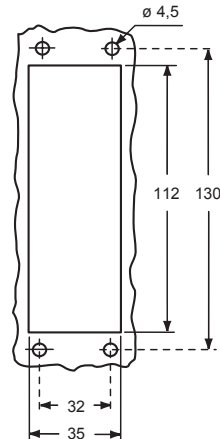

### MAPE

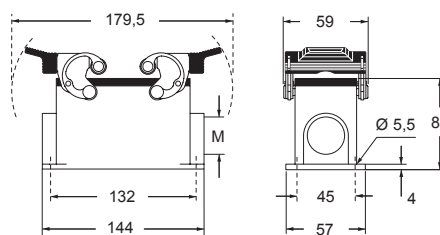

### CHCE

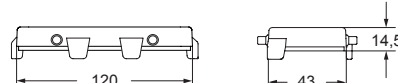

### MHOE (MAOE)

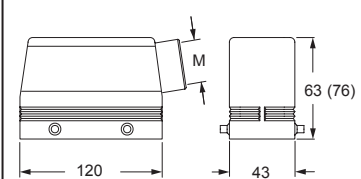

### MHVE (MAVE)

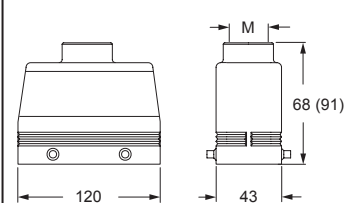

### CHCE G

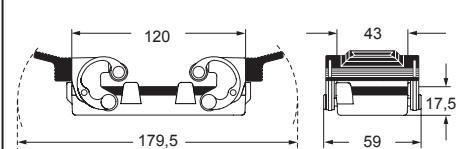

### MAVE G

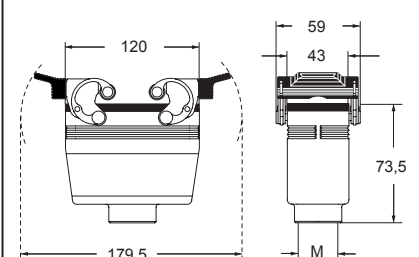

### For fixing on housings

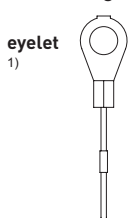

### For fixing on hoods

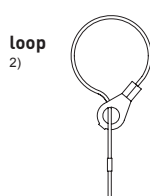

**CALUS** Type 4/4X/12

insulating cable gland or fittings without gasket

cable gland with O-Ring gasket