

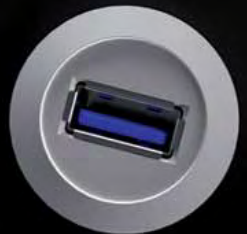

Panel Mount Jacks

USB
FW6
RJ45
HDMI
...

3-4-5



Contents

→ Rontron-R-Juwel jacks	
- USB	page 03
- RJ45	page 06
- HDMI	page 07
- M12	page 07
- Optical fibre	page 07
- Accessories	page 08
→ Rontron-Q-Juwel jacks	
- USB	page 13
- RJ45	page 14
- Accessories	page 14
→ Oktron-Juwel jacks	
- USB	page 17

For detailed information, please refer to www.schlegel.biz and our product catalogue.



RONTRON-R-JUWEL

MADE IN GERMANY



Ø 22.3 mm

Cutout dimensions

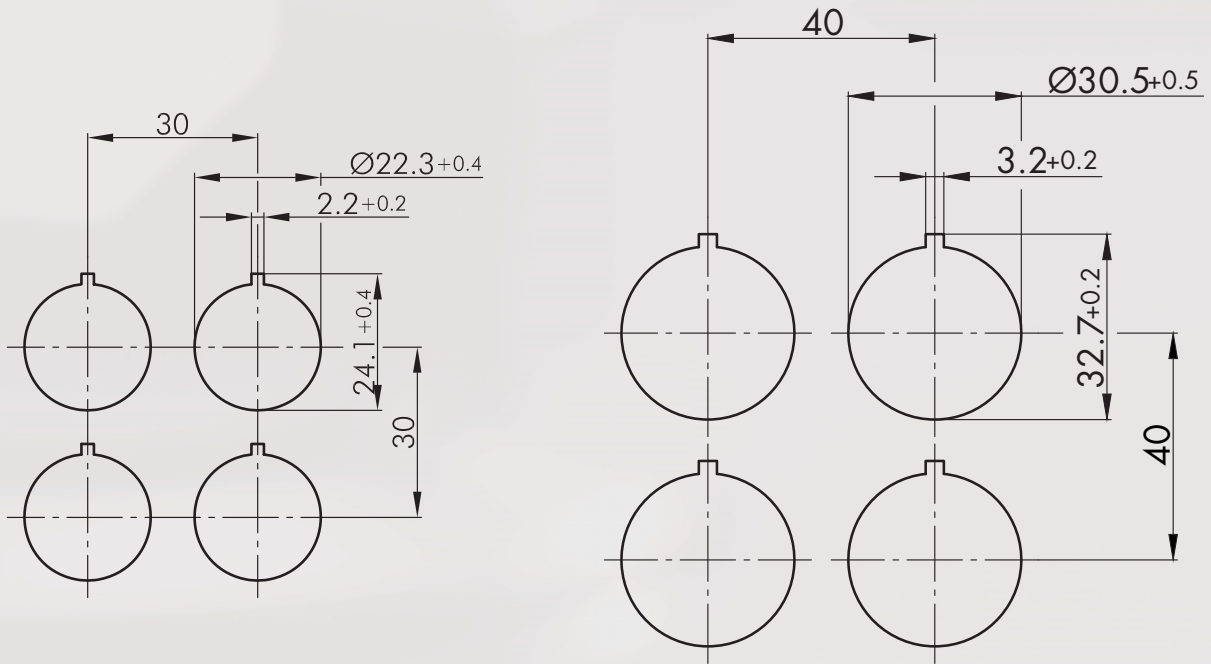

About Us

Pushbuttons/Switches

Panel Mount locks

Emergency-Stop Buttons

Bus Technology

RFID

Enclosures

Pedal Switches

Terminal Blocks

Type Index

Panel mount jacks

other cable lengths on request

Illustration

Dimensions

Description

Type

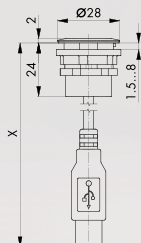

USB2.0 jack A/connector A (60 cm)

front:

USB2.0 jack type A

rear:

USB2.0 cable (length X=600 mm) with plug type A

Attention: Mounting position of the USB jack does not comply with the USB2.0 specification

Front bezel

silver-coloured

stainless steel, polished

black



RRJ_USB

RRJVA_USB

RRJ_USB_SW

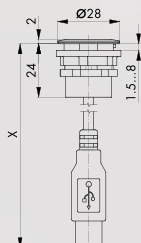

USB2.0 jack A/connector A (150 cm)

front:

USB2.0 jack type A

rear: USB2.0 cable (length X=1500 mm) with plug type A

Attention: Mounting position of the USB jack does not comply with the USB2.0 specification

Front bezel

silver-coloured

stainless steel, polished

black



RRJ_USB_150CM

RRJVA_USB_150CM

RRJ_USB_SW_150CM

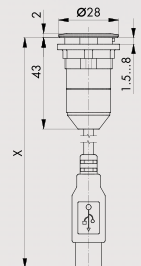

USB3.0 jack A/connector A (60 cm)

front:

USB3.0 jack type A

rear: USB3.0 cable (length X=600 mm) with plug type A

Front bezel

silver-coloured

stainless steel, polished

black



RRJ_USB3

RRJVA_USB3

RRJ_USB3_SW

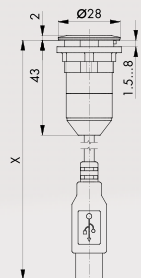

USB3.0 jack A/connector A (150 cm)

front:

USB3.0 jack type A

rear: USB3.0 cable (length X= 1500 mm) with plug type A

Front bezel

silver-coloured

stainless steel, polished

schwarz



RRJ_USB3_150CM

RRJVA_USB3_150CM

RRJ_USB3_SW_150

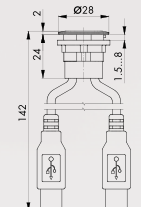

Double USB2.0 jack A/connector A (60 cm)

front:

2x USB2.0 jack type A

rear: 2x USB2.0 cable (length X=600 mm) with plug type A

Front bezel

silver-coloured

stainless steel, polished

black



RRJ_2USB

RRJVA_2USB

RRJ_2USB_SW

RONTRON-R-JUWEL

Ø 22.3 mm

MADE IN GERMANY



About Us

Pushbuttons/Switches

Panel Mount Jacks

Emergency-Stop Buttons

Bus Technology

RFD

Enclosures

Pedal Switches

Terminal Blocks

Type Index

Panel mount jacks

other cable lengths on request

Illustration

Dimensions

Description

Type

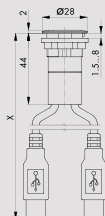

Double USB3.0 jack A/connector A (60 cm)

front:
2x USB3.0 - jack type A
rear:
2x USB3.0 cable (length X=600 mm) with plug type A

Front bezel silver-coloured
 stainless steel, polished
 black

RRJ_2USB3
RRJVA_2USB3
RRJ_2USB3_SW

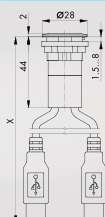

Double USB3.0 jack A/connector A (150 cm)

front:
2x USB3.0 - jack type A
rear:
2x USB3.0 cable (length X=1500 mm) with plug type A

Front bezel silver-coloured
 stainless steel, polished
 black

RRJ_2USB3_150CM
RRJVA_2USB3_150
RRJ_2USB3_SW_150

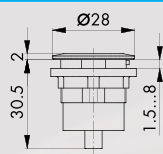

USB2.0 jack A/jack A

front:
USB2.0 jack type A
rear:
USB2.0 jack type A

Front bezel silver-coloured
 stainless steel, polished
 black

RRJ_USB_AA
RRJVA_USB_AA
RRJ_USB_SW_AA

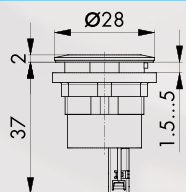

USB3.0 jack A/jack A

pinout 1:1
front:
USB3.0 jack type A
rear:
USB3.0 jack type A

Front bezel silver-coloured
 stainless steel, polished
 black

RRJ_USB3_AA
RRJVA_USB3_AA
RRJ_USB3_SW_AA

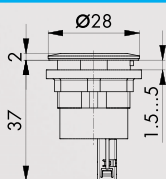

USB3.0 jack A/jack A (twisted data line)

pinout: twisted data line
front:
USB3.0 jack type A
rear:
USB3.0 jack type A

Front bezel silver-coloured
 stainless steel, polished
 black

RRJ_USB3_AA_633
RRJVA_USB3_AA633
RRJ_USB3SWAA_633

Panel mount jacks
other cable lengths on request

Illustration

Dimensions

Description

Type

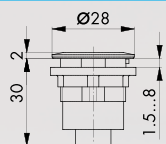

USB2.0 jack A/jack B

front:
USB2.0 jack type A
rear:
USB2.0 jack type B

Front bezel

silver-coloured
stainless steel, polished
black



RRJ_USB_AB
RRJVA_USB_AB
RRJ_USB_SW_AB

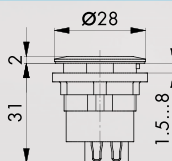

USB2.0 jack B/jack A

front:
USB2.0 jack type B
rear:
USB2.0 jack type A

Front bezel

silver-coloured
stainless steel, polished
black



RRJ_USB_BA
RRJVA_USB_BA
RRJ_USB_SW_BA

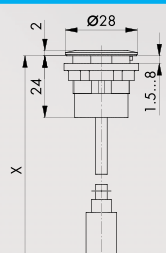
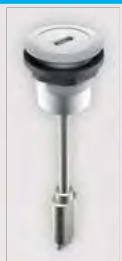

USB2.0 jack C/connector C (60 cm)

front:
USB2.0 jack type C
rear:
USB2.0 cable (length X=600 mm) with plug type C

Front bezel

silver-coloured
stainless steel, polished
black



RRJ_USB_CC_60
RRJVA_USB_CC_60
RRJSW_USB_CC_60

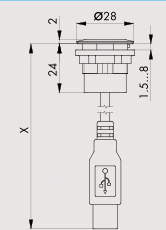

USB2.0 jack C/connector A (60 cm)

front:
USB2.0 jack type C
rear:
USB2.0 cable (length X=600 mm) with plug type A

Front bezel

silver-coloured
stainless steel, polished
black



RRJ_USB_CA_60
RRJVA_USB_CA_60
RRJSW_USB_CA_60

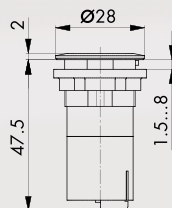

USB charging jack

for charging USB devices in industrial sectors and in public transport
input voltage: 12 and 24 V DC
output voltage: 4.75 - 5.25 V DC output current: 1.5 A

Colour

silver-coloured
stainless steel, polished
black



RRJ_USB_A_5V
RRJVA_USB_A_5V
RRJ_USB_SW_A_5V

RONTRON-R-JUWEL

Ø 22.3 mm

MADE IN GERMANY



About Us

Pushbuttons/Switches

Panel Mount Jacks

Emergency-Stop Buttons

Bus Technology

RFID

Enclosures

Pedal Switches

Terminal Blocks

Type Index

Panel mount jacks

other cable lengths on request

Illustration

Dimensions

Description

Type



Connector for USB charging jacks

SV_FK2,5

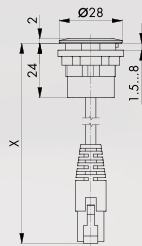

RJ45 jack/connector (60 cm)

front:
RJ45 jack with screen
rear:
cable (length X=600 mm) with RJ45 plug with screen

Front bezel silver-coloured
 stainless steel, polished
 black

RRJ_RJ45
RRJVA_RJ45
RRJ_RJ45_SW

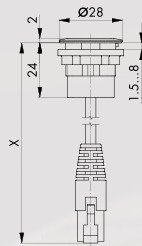

RJ45 jack/connector (150 cm)

front:
RJ45 jack with screen
rear:
cable (length X=1500 mm) with RJ45 plug with screen

Front bezel silver-coloured
 stainless steel, polished
 black

RRJ_RJ45_150CM
RRJVA_RJ45_150CM
RRJ_RJ45SW_150CM

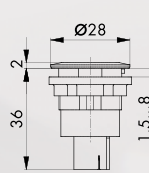

RJ45 jack/jack

front:
RJ45 jack with screen
rear:
RJ45 jack with screen

Front bezel silver-coloured
 stainless steel, polished
 black

RRJ_RJ45_STB
RRJVA_RJ45_STB
RRJ_RJ45_STB_SW

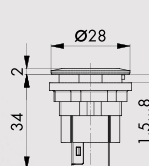

RJ45 jack/jack CAT6

front:
RJ45 jack with screen
rear:
RJ45 jack with screen

Front bezel silver-coloured
 stainless steel, polished
 black

RRJ_RJ45_STBCAT6
RRJVARJ45STBCAT6
RRJRJ45STBCAT6SW

Panel mount jacks

other cable lengths on request

Illustration

Dimensions

Description

Type

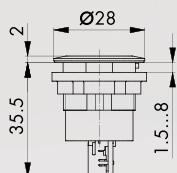

HDMI jack/jack

front:
HDMI jack
rear:
HDMI jack

Front bezel

silver-coloured
stainless steel, polished
black



RRJ_HDMI_STB
RRJVA_HDMI_STB
RRJ_HDMI_STB_SW

IP20

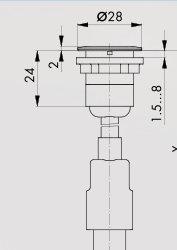

HDMI jack/jack

front:
HDMI jack
rear:
HDMI connector cable length: 60 cm ± 3 cm

Front bezel

silver-coloured
stainless steel, polished
black



RRJ_HDMI
RRJVA_HDMI
RRJ_HDMI_SW

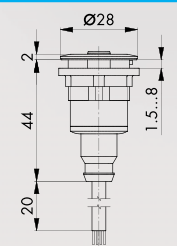

M12 jack 4-pole

front:
M12 jack: 4-pole, A coded
rear:
open cable end (length X=1000 mm)

Front bezel

silver-coloured



RRJ_M124A_100CM



M12 jack 5-pole

front:
M12 jack: 5-pole, A coded
rear:
open cable end (length X=1000 mm)

Front bezel

silver-coloured



RRJ_M125A_100CM

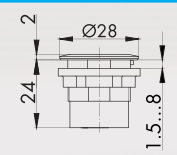

Optical fibres LC jack/LC jack

- LC/LC coupling
- fiber type OM2

Front bezel

silver-coloured



RRJ_LWL_LC_OM2

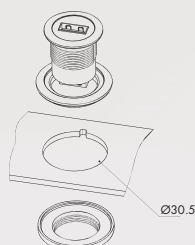

Adapter for panel mount jacks

allows true-to-size mounting of all flush-mounted jacks of the Rontron-R-Juwel series into cut-outs of 30.5 mm dia., the jack is not included in delivery

Colour

silver-coloured



KRJM22R

RONTRON-R-JUWEL

Ø 22.3 mm

MADE IN GERMANY



Accessories for pushbuttons and switches



Illustration Dimensions Description Type

Accessories

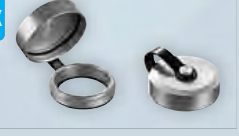
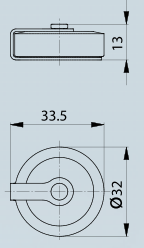
IP69K

Robust protection cap
 - captive lid, threadable
 - suitable for various products of the series Rontron-R-Juwel, Rondex-Juwel and Shortron

Colour	aluminum		SDAL22RR SDVA22RR
	stainless steel, polished		

IP40

Protective lid, sealable

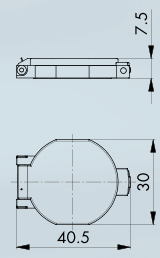
Colour	transparent		KDP22RR
--------	-------------	-------------------------------------------------------------------------------------	----------------

IP65
IP67

Robust protective lid, sealable

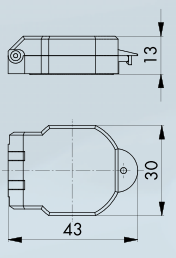
Colour	transparent		KDPR22RR KDPR22RR_SW
	black		

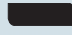
IP67



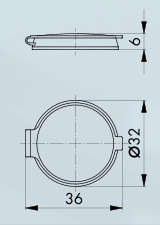

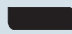
Protective lid made of TPE

Colour	black		AK22RRSW
--------	-------	---------------------------------------------------------------------------------------	-----------------

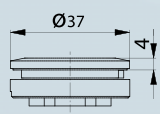
IP65

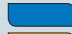
LED light ring for status indication or additional illumination
 - for an additional light signal
 - rated voltage: 24V DC
 - rated current: 25 ... 35 mA (DC)
 - panel cut-out Ø 30.5 mm
 - connection for JST plug ZHR-3
 - tightening torque mounting nut max. 0.25 Nm delivery without actuator

LED colour	blue		LR22K_24B_619
	yellow		LR22K_24Y_619
	white		LR22K_24W_619
	red		LR22K_24R_619
	green		LR22K_24G_619

- About Us
- Pushbuttons/Switches
- Panel Mount Locks
- Emergency-Stop Buttons
- Bus Technology
- RFD
- Enclosures
- Pedal Switches
- Terminal Blocks
- Type Index

Accessories for pushbuttons and switches

Illustration	Dimensions	Description	Type
		Connecting cable for LED light ring with open end, to connect the LED light rings to a voltage supply source length: approx. 80 cm, cross section 0.14 mm ²	VK_JST3_014
IP65 		RGB LED light ring for status indication or illumination - for an additional light signal - one-piece ring (360°) - rated voltage 24V DC - rated current: 25 ... 35 mA (DC) - panel cut-out Ø 30.5 mm - 1 of up to 16.7 million colours can be displayed (colour mixing via PWM signal) - tightening torque mounting nut max. 0.25 Nm	LED colour red/green/blue LR22K_24RGB_619
		Connecting cable for RGB LED light ring with open end, to connect the RGB-LED light rings to a voltage supply source length: approx. 60 cm, cross section 0.14 mm ²	VK_LRR22_RGB
		Fixing nut for an extended clamping range up to 11 mm	M22F
		Mounting tool 22 with torque limitation for the series QUARTEX-R(-JUWEL), KOMBITAST-R-JUWEL, RONDEX, RONDEX-M, RONDEX-JUWEL, RVA, DUX-Basic, SHORTRON, jacks of the ranges RONTRON-R/-Q-JUWEL	S22
		Mounting tool 16 with torque limitation for the series OKTRON, OKTRON-JUWEL, OKTRON-R, RONTRON-R-JUWEL, RONTRON-Q-JUWEL, QUARTRON, QUARTRON-JUWEL, RX-JUWEL	S16

About Us

Pushbuttons/Switches

Panel Mount Jacks

Emergency-Stop Buttons

Bus Technology

RFID

Enclosures

Pedal Switches

Terminal Blocks

Type Index

RONTRON-R-JUWEL

Ø 22.3 mm

MADE IN GERMANY



Accessories for pushbuttons and switches

- About Us
- Pushbuttons/Switches
- Panel Mount Locks
- Emergency-Stop Buttons
- Bus Technology
- RFID
- Enclosures
- Pedal Switches
- Terminal Blocks
- Type Index

Illustration	Dimensions	Description	Type
		Mounting bracket 90° / 1 mounting hole stainless steel 1.4301 for a fast and easy assembly on profiles (slot 8)	S_CW190
		Mounting bracket 90° / 2 mounting holes stainless steel 1.4301 for a fast and easy assembly on profiles (slot 8)	S_CW290
		Mounting bracket 90° / 3 mounting holes stainless steel 1.4301 for a fast and easy assembly on profiles (slot 8)	S_CW390
		Mounting bracket 135° / 1 mounting hole stainless steel 1.4301 for a fast and easy assembly on profiles (slot 8)	S_CW145
		Mounting bracket 135° / 2 mounting holes stainless steel 1.4301 for a fast and easy assembly on profiles (slot 8)	S_CW245
		Mounting bracket 135° / 3 mounting holes stainless steel 1.4301 for a fast and easy assembly on profiles (slot 8)	S_CW345

About Us

Pushbuttons/Switches

→ Panel Mount Jacks

Emergency-Stop Buttons

Bus Technology

RFID

Enclosures

Pedal Switches

Terminal Blocks

Type Index

RONTRON-Q-JUWEL

MADE IN GERMANY



Ø 22.3 mm

Cutout dimensions

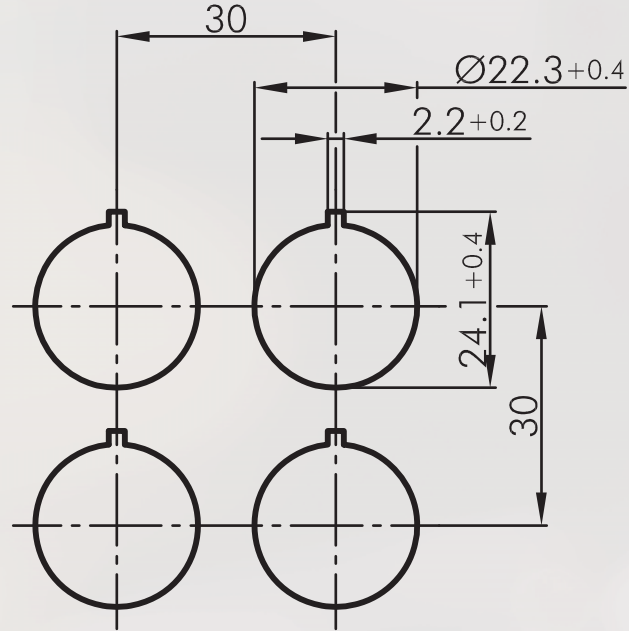

About Us

Pushbuttons/Switches

→ Panel Mount Jacks

Emergency-Stop Buttons

Bus Technology

RFID

Enclosures

Pedal Switches

Terminal Blocks

Type Index

Panel mount jacks

other cable lengths on request

Illustration

Dimensions

Description

Type

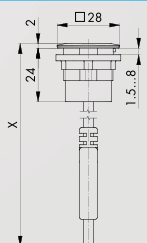

USB2.0 jack A/connector A (60 cm)

front:
USB2.0 jack type A
rear:
USB2.0 cable (length X=600 mm) with plug type A
Attention: Mounting position of the USB jack does not comply with the USB2.0 specification

Front bezel silver-coloured  **RQJ_USB**

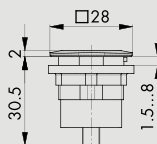

USB2.0 jack A/jack A

front:
USB2.0 jack type A
rear:
USB2.0 jack type A

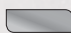
Front bezel silver-coloured  **RQJ_USB_AA**

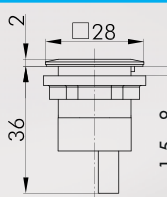

USB3.0 jack A/jack A

front:
USB3.0 jack type A
rear:
USB3.0 jack type A

Front bezel silver-coloured  **RQJ_USB3_AA**

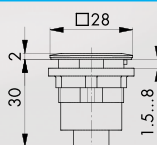

USB2.0 jack A/jack B

front:
USB2.0 jack type A
rear:
USB2.0 jack type B

Front bezel silver-coloured  **RQJ_USB_AB**

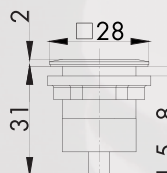

USB2.0 jack B/jack A

front:
USB2.0 jack type B
rear:
USB2.0 jack type A

Front bezel silver-coloured  **RQJ_USB_BA**

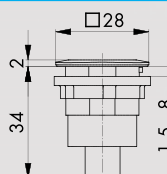

USB2.0 jack B/jack B

front:
USB2.0 jack type B
rear:
USB2.0 jack type B

Front bezel silver-coloured  **RQJ_USB_BB**

About Us

Pushbuttons/Switches

Panel Mount Jacks

Emergency-Stop Buttons

Bus Technology

RFID

Enclosures

Pedal Switches

Terminal Blocks

Type Index

RONTRON-Q-JUWEL

MADE IN GERMANY



Ø 22.3 mm

About Us

Pushbuttons/Switches

Panel Mount Jacks

Emergency-Stop Buttons

Bus Technology

RFID

Enclosures

Pedal Switches

Terminal Blocks

Type Index

Panel mount jacks

other cable lengths on request

Illustration

Dimensions

Description

Type

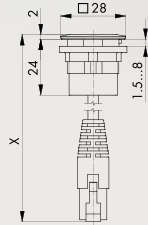

RJ45 jack/connector (60 cm)

front:
RJ45 jack with screen
rear:
cable (length X=600 mm) with RJ45 plug with screen

Front bezel silver-coloured  **RQJ_RJ45**

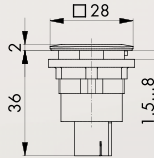

RJ45 jack/jack

front:
RJ45 jack with screen
rear:
RJ45 jack with screen

Front bezel silver-coloured  **RQJ_RJ45_STB**

Accessories

IP40

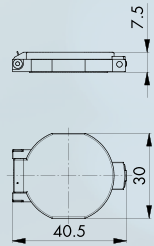

Protective lid, sealable

Colour transparent  **KDP22RR**

IP65
IP67

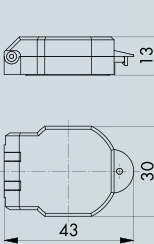

Robust protective lid, sealable

Colour transparent  **KDPR22RR**



Fixing nut for an extended clamping range up to 11 mm

M22F





Mounting tool 22

S22

with torque limitation for the series QUARTEX-R(JUWEL), KOMBITAST-R-JUWEL, RONDEX, RONDEX-M, RONDEX-JUWEL, RVA, DUX-Basic, SHORTRON, jacks of the ranges RONTRON-R/-Q-JUWEL

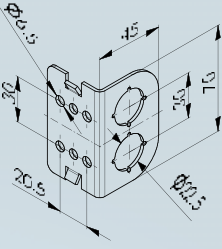
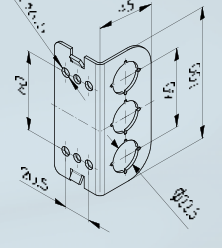
Accessories for pushbuttons and switches

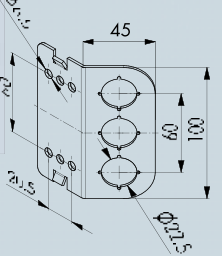
Illustration	Dimensions	Description	Type
		Mounting bracket 90° / 1 mounting hole stainless steel 1.4301 for a fast and easy assembly on profiles (slot 8)	S_CW190
		Mounting bracket 90° / 2 mounting holes stainless steel 1.4301 for a fast and easy assembly on profiles (slot 8)	S_CW290
		Mounting bracket 90° / 3 mounting holes stainless steel 1.4301 for a fast and easy assembly on profiles (slot 8)	S_CW390
		Mounting bracket 135° / 1 mounting hole stainless steel 1.4301 for a fast and easy assembly on profiles (slot 8)	S_CW145
		Mounting bracket 135° / 2 mounting holes stainless steel 1.4301 for a fast and easy assembly on profiles (slot 8)	S_CW245
		Mounting bracket 135° / 3 mounting holes stainless steel 1.4301 for a fast and easy assembly on profiles (slot 8)	S_CW345

About Us

Pushbuttons/Switches

→ Panel Mount Jocks

Emergency-Stop Buttons

Bus Technology

RFID

Enclosures

Pedal Switches

Terminal Blocks

Type Index

Cutout dimensions

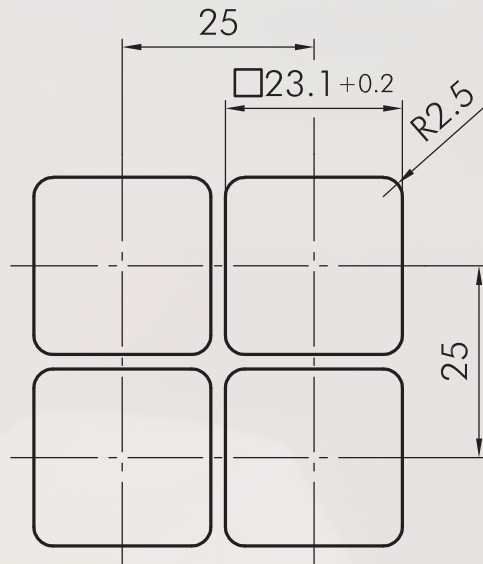

Panel mount jacks

other cable lengths on request

Illustration

Dimensions

Description

Type

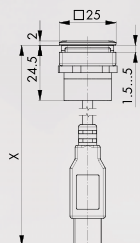

USB2.0 jack A/connector A (60 cm)

front:
USB2.0 jack type A
rear:
USB2.0 cable (length X=600 mm) with plug type A

Front bezel black  **OKJ_USB**

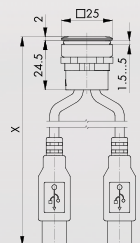

Double USB2.0 jack A/connector A (60 cm)

front:
2x USB3.0 jack type A
rear:
2x USB2.0 cable (length X=600 mm) with plug type A

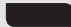
Front bezel black  **OKJ_2USB**

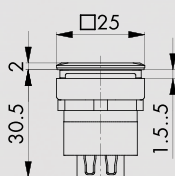

USB2.0 jack A/jack A

front:
USB2.0 jack type A
rear:
USB2.0 jack type A

Front bezel black  **OKJ_USB_AA**

Accessories

IP40

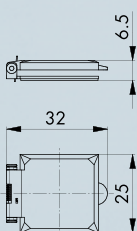

Protective lid

for pushbuttons and jacks of the OKTRON-JUWEL series

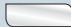
Colour transparent  **KDOKJ**



Mounting tool 22

S22

with torque limitation for the series QUARTEX-R(-JUWEL), KOMBITAST-RJUWEL, RONDEX, RONDEX-M, RONDEX-JUWEL, RVA, DUX-Basic, SHORTRON, jacks of the ranges RONTRON-R/-QJUWEL

About Us

Pushbuttons/Switches

Panel Mount Jacks

Emergency-Stop Buttons

Bus Technology

RFID

Enclosures

Pedal Switches

Terminal Blocks

Type Index



Georg Schlegel GmbH & Co. KG
Kapellenweg 4
88525 Dürmentingen / Germany

☎ +49 7371 502-0
📠 +49 7371 502 49
@ info@schlegel.biz
🌐 www.schlegel.biz



Subsidiaries:

Schlegel Elektrokontakt GmbH
Schönbachstr. 93
04299 Leipzig / **Germany**

Tel.: +49 (0)341 / 8 68 72-0
Fax: +49 (0)341 / 8 68 72 43
E-Mail: leipzig@schlegel.biz
www.schlegel.biz

Georg Schlegel Vertriebs Ges.mbH
Samuel Morse-Straße 7
2700 Wiener Neustadt / **Austria**

Tel.: +43 (0)2622 / 8 13 13
Fax: +43 (0)2622 / 8 13 13-19
E-Mail: schlegel@schlegel.at
www.schlegel.at