

MADE IN GERMANY



proboxx

synergy of design and function



GERMAN
DESIGN
AWARD
SPECIAL
2021



Focus Open 2021
Special Mention



reddot winner 2021

1-2-3

modern
versatile
individual



 <p>GERMAN DESIGN AWARD SPECIAL 2021</p>	 <p>Focus Open 2021 Internationaler Designpreis Baden-Württemberg</p>	 <p>GOOD DESIGN</p>
 <p>reddot winner 2021</p>		

→ Enclosure series proboxx

Modern, elegant and compact enclosure with a maximum of flexibility

- **Empty enclosure** page 10
- **M12 enclosure** page 11
- **IO-Link** page 15
- **AS-Interface** page 19
- **sWave® radio technology** page 23



→ The proboxx in detail

Particular attention was given to the design of the proboxx. Therefore, the screw fitting was deliberately placed on the bottom side, so the enclosure's appearance is not disturbed by exposed screw heads. This aesthetic detail corresponds with the added value of safety: The enclosure can not be opened without dismounting it. For the labelling of the pushbuttons and switches special labels have been developed which fit perfectly into the design and can be fixed easily by clipping on. The inscription is custom-made and engraved by lasering.

- high-quality, stable enclosure made of polyamide
- appealing design
- innovative mounting mechanism for base, wall and profile mounting
- asymmetrical placement on guard lockings
- screw fitting on the bottom
- labels to clip on (laser marked)
- degree of protection IP65
- dimensions
 - width 52 mm
 - height 44 mm
 - length without M12 connector 177 mm, 141 mm,
105 mm, 69 mm
 - length with M12 connector 189 mm, 153 mm,
117 mm, 81 mm
- pushbuttons and switches
 - pilot lights
 - pushbuttons
 - selector/key switches
 - emergency-stop

→ proboxx: Synergy of design and function

Flexible, functional and elegant - these are the characteristics our new enclosure series proboxx made in Dürmentingen features. With the new product line we - the expert for pushbuttons and switches - are complementing our portfolio of enclosures by a particularly class and also practical variant making daily work easier.

We currently offer the proboxx as an empty or an assembled enclosure. The assembled variant is available for four different systems.

- Empty enclosure
- Assembled M12 enclosure
- Assembled IO-Link enclosure
- Assembled AS-Interface enclosure
- Assembled enclosure with sWave® radio technology





How to configure and order your probbox

Orders and individual assemblies of the probbox can be submitted via the new Schlegel online configurator for enclosures. Based on your requirements, you can select an empty enclosure or an assembled one and choose the most suitable assembly for your application from a variety of sizes and systems.

→ probbox.schlegel.biz



Get started with the startboxx

Would you like to get familiar with the probbox now? Then simply order our startboxx! The startboxx is a fully functional probbox equipped with 3 pushbuttons and switches. The probbox is easy to connect via the M12 connector and can be used immediately.

→ **Simple**

Thanks to the new innovative mounting mechanism the enclosures are quick and easy to assemble. The enclosure is securely fixed by simply sliding and snapping it in.



→ **Functional**

- direct integration in IO-Link or AS-Interface systems
- asymmetric fixing for safety gates
- optional, flexible labelling option



→ **Plug & Work**

Simply to connect with M12 connector, no wiring necessary.



→ **Flexible**

- up to 4 holes for pushbuttons and switches
- various connection options (M12, M16 cable gland, radio system)
- available as pre-equipped or empty enclosure



→ **Valuable**

Appealing, high-quality and modern design.



→ **Reliable**

- stable plastic enclosure
- degree of protection IP65





→ Empty enclosure

- individual use
- with predetermined breaking point for M16 cable glands
- without predetermined breaking point for the use with radio systems or special connectors



→ Assembled M12 enclosure

- for conventional wiring
- two M12 connectors
- the emergency-stop is connected separately via the second M12 connector

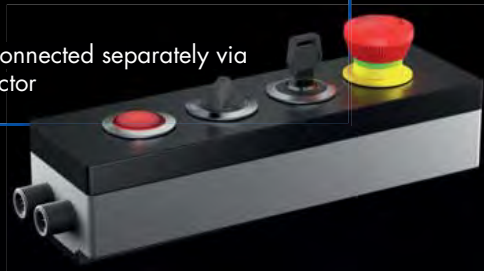

→ Assembled IO-Link enclosure

- IO-Link certified
- two M12 connectors (IO-Link / emergency-stop (AIDA))
- IO-Link status indication
- The following features can be parameterised:
 - dimming or night design of all LEDs
 - operating hours meter
 - monitoring of switching cycles (lifetime) of each pushbutton or switch
 - monitoring of the status indication

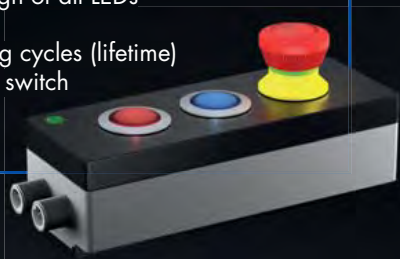



→ Assembled AS-Interface enclosure

- AS-Interface certified
- two M12 connectors (bus is looped through)
- AS-Interface status indication
- Safety@Work (emergency-stop)



→ Assembled enclosure with sWave® radio technology

Transmitter

- sWave® technology of steute
- frequency range 868 MHz (EU and China)
- bidirectional communication (transmitter electronics with long-life battery)
- LED for status indication (monitoring of switching states and battery)
- range of up to 450 m in the open field and up to 40 m indoors

Receiver

- sWave® technology of steute
- frequency range 868 MHz (EU and China)
- 4 potential-free relay outputs (NO)
- learning mode (assignment of outputs)
- Up to 40 transmitters (button/switch) can be managed on one receiver
- LED status indication (switching states)
- range of up to 450 m in the open field and up to 40 m indoors



Insulated plastic enclosures



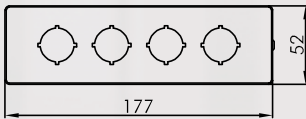
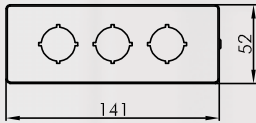
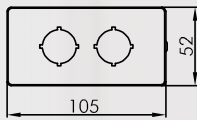
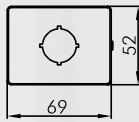

Illustration Dimensions Description Type

IP65
IP67



Empty enclosure with predetermined breaking point

for pushbuttons and switches of the SHORTRON series

Equipped	no	
Material	PA6	
Cable entry	break-through wall M16	
Mounting holes	1	
Panel cut-out	Ø 22.3 mm	 PXD1
Colour	dark-grey bottom part/black cover	
Mounting holes	2	
Panel cut-out	Ø 22.3 mm	 PXD2
Colour	dark-grey bottom part/black cover	
Mounting holes	3	
Panel cut-out	Ø 22.3 mm	 PXD3
Colour	dark-grey bottom part/black cover	
Mounting holes	4	
Panel cut-out	Ø 22.3 mm	 PXD4
Colour	dark-grey bottom part/black cover	

IP65
IP67

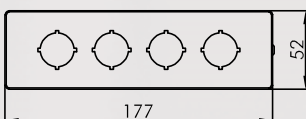
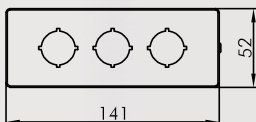
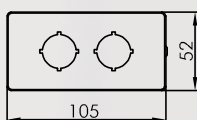
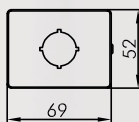
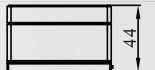

Empty enclosure

without connector for the equipment with individual connectors or for radio application

for pushbuttons and switches of the SHORTRON series

Equipped	no	
Material	PA6	
Cable entry	no	
Mounting holes	1	
Panel cut-out	Ø 22.3 mm	 PX01
Colour	dark-grey bottom part/black cover	
Mounting holes	2	
Panel cut-out	Ø 22.3 mm	 PX02
Colour	dark-grey bottom part/black cover	
Mounting holes	3	
Panel cut-out	Ø 22.3 mm	 PX03
Colour	dark-grey bottom part/black cover	
Mounting holes	4	
Panel cut-out	Ø 22.3 mm	 PX04
Colour	dark-grey bottom part/black cover	

Equipped insulated plastic enclosures M12

Emergency-stop with 2 NC contacts (conventionally wired), pushbutton, selector/key switch with NO contacts.

Illustration Dimensions Description Type

IP65

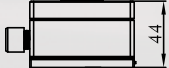
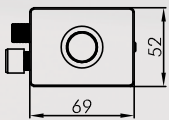

**Enclosure with M12 connector
Pushbutton**

- equipped with 1 pushbutton RRJT (with blank nameplate and transparent clear lens)
- operating voltage 24 V AC/DC

Equipped	yes
Material	PA6
Cable entry	5-pole M12, A coded
Mounting holes	1

PXM1M0000

IP65

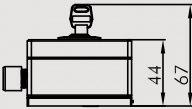
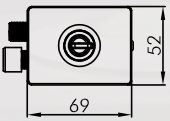
**Enclosure with M12 connector
Key switch**

- equipped with 1 two-position key switch RRJSSA15
- operating voltage 24 V AC/DC

Equipped	yes
Material	PA6
Cable entry	5-pole M12, A coded
Mounting holes	1

PXM1M0001

IP65

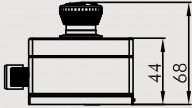
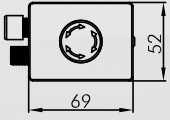
**Enclosure with M12 connector
Emergency-stop**

- equipped with 1 emergency-stop RRJUV
- pin assignment emergency-stop: AIDA
- operating voltage 24 V AC/DC

Equipped	yes
Material	PA6
Cable entry	5-pole M12, A coded, AIDA
Mounting holes	1

PXM1M1000

- About Us
- Pushbuttons / Switches
- Panel Mount Jacks
- Emergency-Stop Buttons
- Bus Technology
- RFID
- Enclosures
- Pedal Switches
- Terminal Blocks
- Type Index

Equipped insulated plastic enclosures M12

Emergency-stop with 2 NC contacts (conventionally wired), pushbutton, selector/key switch with NO contacts.

Illustration

Dimensions

Description

Type

IP65

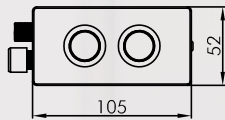
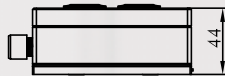

**Enclosure with M12 connector
2 pushbuttons**

- equipped with 2 pushbuttons RRJT (with blank nameplates and transparent clear lenses)

- operating voltage 24 V AC/DC

Equipped yes

Material PA6

Cable entry 8-pole M12, A coded

Mounting holes 2

PXM2M0002

IP65

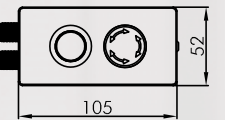

**Enclosure with M12 connector
Pushbutton, emergency-stop**

- equipped with 1 pushbutton RRJT (with blank nameplate and transparent clear lens) and 1 emergency-stop RRJUV

- pin assignment emergency-stop: AIDA

- operating voltage 24 V AC/DC

Equipped yes

Material PA6

Cable entry 2x M12 5-pole (AIDA)/5 pole, A coded

Mounting holes 2

PXM2M1001

IP65

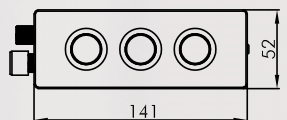
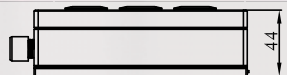

**Enclosure with M12 connector
3 pushbuttons**

- equipped with 3 pushbuttons RRJT (with blank nameplates and transparent clear lenses)

- operating voltage 24 V AC/DC

Equipped yes

Material PA6

Cable entry 12-pole M12, A coded

Mounting holes 3

PXM3M0003

Equipped insulated plastic enclosures M12

Emergency-stop with 2 NC contacts (conventionally wired), pushbutton, selector/key switch with NO contacts.

Illustration

Dimensions

Description

Type

IP65

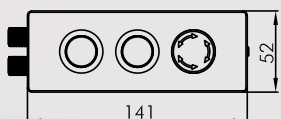
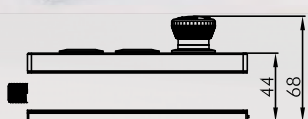

**Enclosure with M12 connector
2 pushbuttons, emergency-stop**

- equipped with 2 pushbuttons RRJT (with blank nameplates and transparent clear lenses) and 1 emergency-stop RRJUV
- pin assignment emergency-stop: AIDA
- operating voltage 24 V AC/DC

Equipped yes
Material PA6
Cable entry 2x M12 5-pole (AIDA)/8-pole, A coded
Mounting holes 3

PXM3M1002

IP65

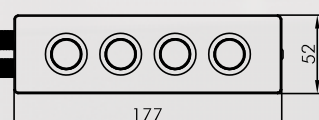
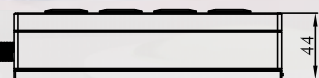

**Enclosure with M12 connector
4 pushbuttons**

- equipped with 4 pushbuttons RRJT (with blank nameplates and transparent clear lenses)
- operating voltage 24 V AC/DC

Equipped yes
Material PA6
Cable entry 2x M12 8-pole, A coded

Mounting holes 4

PXM4M0004

IP65



**Enclosure with M12 connector
3 pushbuttons, emergency-stop**

- equipped with 3 pushbuttons RRJT (with blank nameplates and transparent clear lenses) and 1 emergency-stop RRJUV
- pin assignment emergency-stop: AIDA
- operating voltage 24 V AC/DC

Equipped yes
Material PA6
Cable entry 2x M12 5-pole (AIDA)/12-pole, A coded

Mounting holes 4

PXM4M1003

Equipped insulated plastic enclosures M12

Emergency-stop with 2 NC contacts (conventionally wired), pushbutton, selector/key switch with NO contacts.

Illustration

Dimensions

Description

Type

IP65



**Enclosure with M12 connector
Key switch, 2 pushbuttons, emergency-stop**

- equipped with 1 key switch RRJSSA15, 2 pushbuttons RRJT (with blank nameplates and transparent clear lenses) and 1 emergency-stop RRJUV
- pin assignment emergency-stop: AIDA
- operating voltage 24 V AC/DC

Equipped	yes
Material	PA6
Cable entry	2x M12 5-pole (AIDA)/12-pole, A coded
Mounting holes	4

PXM4M1004

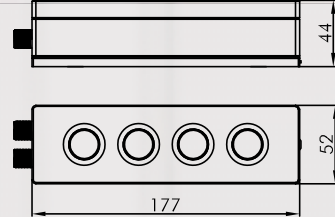

**customised configuration of the proboxx
under proboxx.schlegel.biz**

Equipped insulated plastic enclosures IO-Link

Emergency-stop with 2 NC contacts (conventionally wired), pushbutton, selector/key switch with NO contacts.



Illustration Dimensions Description Type

IP65

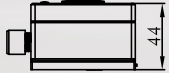
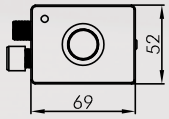
Enclosure for IO-Link interface Pushbutton

- IO-Link certified
- equipped with 1 pushbutton ST (with blank nameplate and transparent clear lens)
- IO-Link status indication
- IODD file via IODD finder
- class A

Parameterisation

- dimming and night design of all LEDs
- operating hours meter
- monitoring of switching cycles of each pushbutton or switch
- monitoring of status indication

Equipped	yes
Material	PA6
Cable entry	5-pole M12, A coded
Mounting holes	1

PXI1M0005

IP65

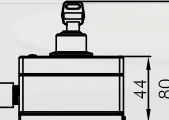
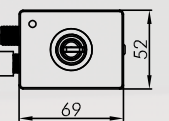
Enclosure for IO-Link interface Key switch

- IO-Link certified
- equipped with 1 key switch SSSA15
- IO-Link status indication
- IODD file via IODD finder
- class A

Parameterisation

- operating hours meter
- monitoring of switching cycles of each pushbutton or switch
- monitoring of status indication

Equipped	yes
Material	PA6
Cable entry	5-pole M12, A coded
Mounting holes	1

PXI1M0006

IP65

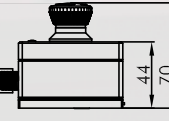
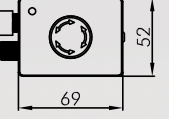
Enclosure for IO-Link interface Emergency-stop

- equipped with 1 emergency-stop FRVKZ
- pin assignment emergency-stop: AIDA

Equipped	yes
Material	PA6
Cable entry	5-pole M12, A coded, AIDA
Mounting holes	1

PXI1M1005

About Us

Pushbuttons/Switches

Panel Mount Jacks

Emergency-Stop Buttons

Bus Technology

RFID

Enclosures

Pedal Switches

Terminal Blocks

Type Index

Equipped insulated plastic enclosures IO-Link

Emergency-stop with 2 NC contacts (conventionally wired), pushbutton, selector/key switch with NO contacts.



Illustration

Dimensions

Description

Type

IP65

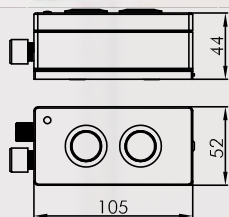

**Enclosure for IO-Link interface
2 pushbuttons**

- IO-Link certified
- equipped with 2 pushbuttons ST (with blank nameplates and transparent clear lenses)
- IO-Link status indication
- IODD file via IODD finder
- class A

Parameterisation

- dimming and night design of all LEDs
- operating hours meter
- monitoring of switching cycles of each pushbutton or switch
- monitoring of status indication

Equipped yes
Material PA6
Cable entry 5-pole M12, A coded

Mounting holes 2

PX12M0007

IP65

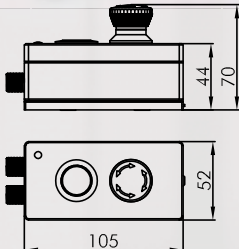

**Enclosure for IO-Link interface
Pushbutton, emergency-stop**

- IO-Link certified
- equipped with 1 pushbutton ST (with blank nameplate and transparent clear lens) and 1 emergency-stop FRVKKO
- pin assignment emergency-stop: AIDA
- IO-Link status indication
- IODD file via IODD finder
- class A

Parameterisation

- dimming and night design of all LEDs
- operating hours meter
- monitoring of switching cycles of each pushbutton or switch
- monitoring of status indication

Equipped yes
Material PA6
Cable entry 2x M12 5-pole (AIDA)/5 pole, A coded

Mounting holes 2

PX12M1006

IP65

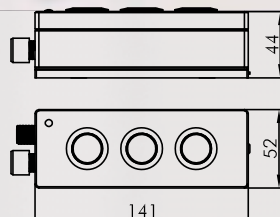

**Enclosure for IO-Link interface
3 pushbuttons**

- IO-Link certified
- equipped with 3 pushbuttons ST (with blank nameplates and transparent clear lenses)
- IO-Link status indication
- IODD file via IODD finder
- class A

Parameterisation

- dimming and night design of all LEDs
- operating hours meter
- monitoring of switching cycles of each pushbutton or switch
- monitoring of status indication

Equipped yes
Material PA6
Cable entry 5-pole M12, A coded

Mounting holes 3

PX13M0008

Equipped insulated plastic enclosures IO-Link

Emergency-stop with 2 NC contacts (conventionally wired), pushbutton, selector/key switch with NO contacts.



Illustration

Dimensions

Description

Type

IP65

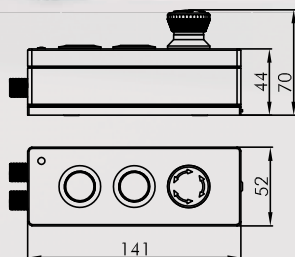

**Enclosure for IO-Link interface
2 pushbuttons, emergency-stop**

- IO-Link certified
- equipped with 2 pushbuttons ST (with blank nameplates and transparent clear lenses) and 1 emergency-stop FRVKKO
- pin assignment emergency-stop: AIDA
- IO-Link status indication
- IODD file via IODD finder
- class A

Parameterisation

- dimming and night design of all LEDs
- operating hours meter
- monitoring of switching cycles of each pushbutton or switch
- monitoring of status indication

Equipped yes
Material PA6
Cable entry 2x M12 5-pole (AIDA)/5 pole, A coded

Mounting holes 3

PXI3M1007

IP65

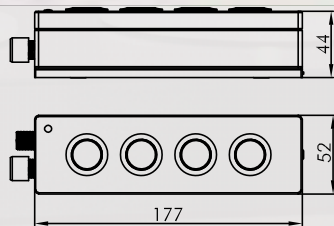

**Enclosure for IO-Link interface
4 pushbuttons**

- IO-Link certified
- equipped with 4 pushbuttons ST (with blank nameplates and transparent clear lenses)
- IO-Link status indication
- IODD file via IODD finder
- class A

Parameterisation

- dimming and night design of all LEDs
- operating hours meter
- monitoring of switching cycles of each pushbutton or switch
- monitoring of status indication

Equipped yes
Material PA6
Cable entry 5-pole M12, A coded

Mounting holes 4

PXI4M0009

About Us

Pushbuttons/Switches

Panel Mount Jacks

Emergency-Stop Buttons

Bus Technology

RFID

→ Enclosures

Pedal Switches

Terminal Blocks

Type Index

Equipped insulated plastic enclosures IO-Link
Emergency-stop with 2 NC contacts (conventionally wired), pushbutton, selector/key switch with NO contacts.

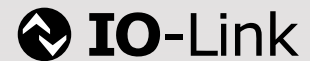

Illustration

Dimensions

Description

Type

IP65

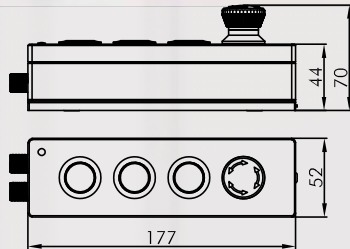

**Enclosure for IO-Link interface
3 pushbuttons, emergency-stop**

- IO-Link certified
- equipped with 3 pushbuttons ST (with blank nameplates and transparent clear lenses) and 1 emergency-stop FRVKKO
- pin assignment emergency-stop: AIDA
- IO-Link status indication
- IODD file via IODD finder
- class A

Parameterisation

- dimming and night design of all LEDs
- operating hours meter
- monitoring of switching cycles of each pushbutton or switch
- monitoring of status indication

Equipped yes
Material PA6
Cable entry 2x M12 5-pole (AIDA)/5 pole, A coded

Mounting holes 4

PXI4M1008

IP65

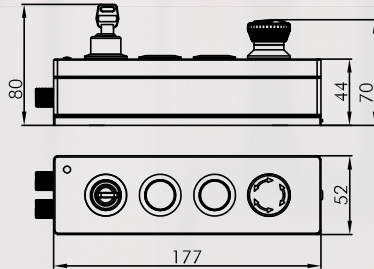

**Enclosure for IO-Link interface
Key switch, 2 pushbuttons, emergency-stop**

- IO-Link certified
- equipped with 1 key switch SSSA15, 2 pushbuttons ST (with blank nameplates and transparent clear lenses) and 1 emergency-stop FRVKKO
- pin assignment emergency-stop: AIDA
- IO-Link status indication
- IODD file via IODD finder
- class A

Parameterisation

- dimming and night design of all LEDs
- operating hours meter
- monitoring of switching cycles of each pushbutton or switch
- monitoring of status indication

Equipped yes
Material PA6
Cable entry 2x M12 5-pole (AIDA)/5 pole, A coded

Mounting holes 4

PXI4M1009

**customised configuration of the proboxx
under proboxx.schlegel.biz**

Equipped insulated plastic enclosures AS-Interface

Emergency-stop with 2 NC contacts (conventionally wired), pushbutton, selector/key switch with NO contacts.



Illustration Dimensions Description Type

IP65

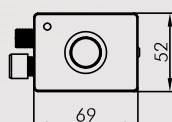
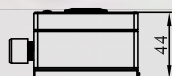

Enclosure with AS-i interface Pushbutton

- AS-Interface certified
- equipped with 1 pushbutton ST (with blank nameplate and transparent clear lens)
- specification 3.0 / 1A/B address
- profile S-7.A.7.7
- ASI status indication
- total power consumption ≤ 200 mA

Equipped yes
Material PA6
Cable entry 2x M12 5-pole, A coded

Mounting holes 1

PXA1M0010

IP65

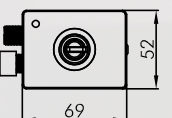
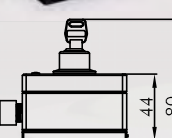

Enclosure with AS-i interface Key switch

- AS-Interface certified
- equipped with 1 key switch SSSA15
- specification 3.0 / 1A/B address
- profile S-7.A.7.7
- ASI status indication
- total power consumption ≤ 200 mA

Equipped yes
Material PA6
Cable entry 2x M12 5-pole, A coded

Mounting holes 1

PXA1M0011

IP65

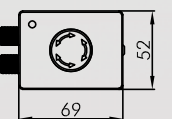

Enclosure with AS-i interface Emergency-stop

- AS-Interface certified
- equipped with 1 emergency-stop FRVKZ
- Safety@Work
- specification 2.1
- profile S-7.B.E
- ASI status indication
- total power consumption ≤ 200 mA

Equipped yes
Material PA6
Cable entry 2x M12 5-pole, A coded

Mounting holes 1

PXA1M1010

About Us

Pushbuttons / Switches

Panel Mount Jacks

Emergency-Stop Buttons

Bus Technology

RFID

→ Enclosures

Pedal Switches

Terminal Blocks

Type Index

Equipped insulated plastic enclosures AS-Interface

Emergency-stop with 2 NC contacts (conventionally wired), pushbutton, selector/key switch with NO contacts.



Illustration Dimensions Description Type

IP65

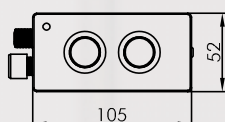

**Enclosure with AS-i interface
2 pushbuttons**

- AS-Interface certified
- equipped with 2 pushbuttons ST (with blank nameplates and transparent clear lenses)
- specification 3.0 / 1A/B address
- profile S-7.A.7.7
- ASI status indication
- total power consumption ≤ 200 mA

Equipped yes
Material PA6
Cable entry 2x M12 5-pole, A coded
Mounting holes 2

PXA2M0012

IP65

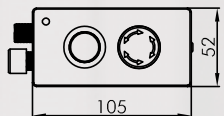
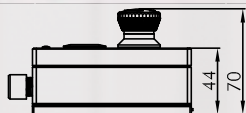

**Enclosure with AS-i interface
Pushbutton, emergency-stop**

- AS-Interface certified
- equipped with 1 pushbutton ST (with blank nameplate and transparent clear lens) and 1 emergency-stop FRVKOO
- specification 3.0 / 1A/B address
- profile S-7.A.7.7
- Safety@Work (emergency-stop)
- specification 2.1
- profile S-7.B.E
- ASI status indication
- total power consumption ≤ 200 mA

Equipped yes
Material PA6
Cable entry 2x M12 5-pole, A coded
Mounting holes 2

PXA2M1011

IP65

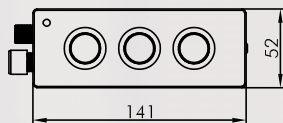

**Enclosure with AS-i interface
3 pushbuttons**

- AS-Interface certified
- equipped with 3 pushbuttons ST (with blank nameplates and transparent clear lenses)
- specification 3.0 / 1A/B address
- profile S-7.A.7.7
- ASI status indication
- total power consumption ≤ 200 mA

Equipped yes
Material PA6
Cable entry 2x M12 5-pole, A coded
Mounting holes 3

PXA3M0013

Equipped insulated plastic enclosures AS-Interface

Emergency-stop with 2 NC contacts (conventionally wired), pushbutton, selector/key switch with NO contacts.



Illustration Dimensions Description Type

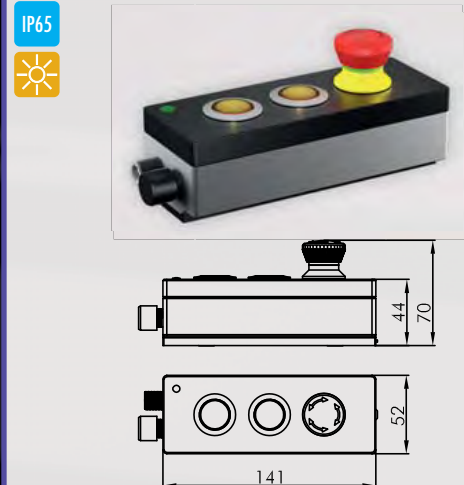

**Enclosure with AS-i interface
2 pushbuttons, emergency-stop**

- AS-Interface certified
 - equipped with 2 pushbuttons ST (with blank nameplates and transparent clear lenses) and 1 emergency-stop FRVKKO
 - specification 3.0 / 1A/B address
 - profile S-7.A.7.7
 - Safety@Work (emergency-stop)
 - specification 2.1
 - profile S-7.B.E
 - ASI status indication
 - total power consumption ≤ 200 mA
- | | |
|----------------|------------------------|
| Equipped | yes |
| Material | PA6 |
| Cable entry | 2x M12 5-pole, A coded |
| Mounting holes | 3 |

PXA3M1012



**Enclosure with AS-i interface
4 pushbuttons**

- AS-Interface certified
 - equipped with 4 pushbuttons ST (with blank nameplates and transparent clear lenses)
 - specification 3.0 / 1A/B address
 - profile S-7.A.7.7
 - ASI status indication
 - total power consumption ≤ 200 mA
- | | |
|----------------|------------------------|
| Equipped | yes |
| Material | PA6 |
| Cable entry | 2x M12 5-pole, A coded |
| Mounting holes | 4 |

PXA4M0014



**Enclosure with AS-i interface
3 pushbuttons, emergency-stop**

- AS-Interface certified
 - equipped with 3 pushbuttons ST (with blank nameplates and transparent clear lenses) and 1 emergency-stop FRVKKO
 - specification 3.0 / 1A/B address
 - profile S-7.A.7.7
 - Safety@Work (emergency-stop)
 - specification 2.1
 - profile S-7.B.E
 - ASI status indication
 - total power consumption ≤ 200 mA
- | | |
|----------------|------------------------|
| Equipped | yes |
| Material | PA6 |
| Cable entry | 2x M12 5-pole, A coded |
| Mounting holes | 4 |

PXA4M1013

Equipped insulated plastic enclosures AS-Interface

Emergency-stop with 2 NC contacts (conventionally wired), pushbutton, selector/key switch with NO contacts.



Illustration

Dimensions

Description

Type

IP65

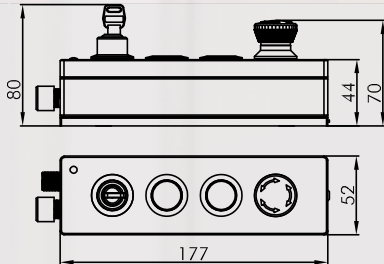

**Enclosure with AS-i interface
Key switch, 2 pushbuttons, emergency-stop**

- AS-Interface certified
- equipped with 1 key switch SSSA15, 2 pushbuttons ST (with blank nameplates and transparent clear lenses) and 1 emergency-stop FRVKOO
- specification 3.0 / 1A/B address
- profile S-7.A.7.7
- Safety@Work (emergency-stop)
- specification 2.1
- profile S-7.B.E
- ASI status indication
- total power consumption ≤ 200 mA

Equipped	yes
Material	PA6
Cable entry	2x M12 5-pole, A coded
Mounting holes	4

PXA4M1014

**customised configuration of the proboxx
under proboxx.schlegel.biz**

Equipped insulated plastic enclosures with sWave® radio technology

Emergency-stop with 2 NC contacts (conventionally wired), pushbutton, selector/key switch with NO contacts.

sWave®

Illustration Dimensions Description Type

IP65

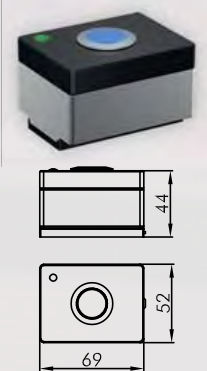

**Enclosure with radio technology
Pushbutton**

- equipped with 1 pushbutton ST (without nameplate, with white non-transparent lens)
- sWave® radio technology
- frequency 868.3 MHz (EU, China)
- long-life battery + performance monitoring
- bidirectional communication
- LED status indication
- range of up to 450 m in the open field and up to 40 m indoors

Equipped	yes
Material	PA6
Mounting holes	1

PXF1M0015

IP65

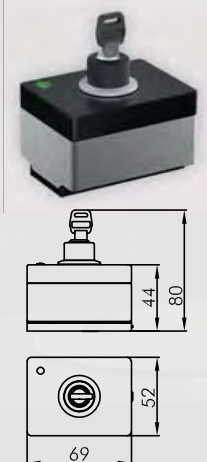

**Enclosure with radio technology
Key switch**

- equipped with 1 key switch SSSA15
- sWave® radio technology
- frequency 868.3 MHz (EU, China)
- long-life battery + performance monitoring
- bidirectional communication
- LED status indication
- range of up to 450 m in the open field and up to 40 m indoors

Equipped	yes
Material	PA6
Mounting holes	1

PXF1M0016

IP65



**Enclosure with radio technology
2 pushbuttons**

- equipped with 2 pushbuttons ST (without nameplates, with white non-transparent lenses)
- sWave® radio technology
- frequency 868.3 MHz (EU, China)
- long-life battery + performance monitoring
- bidirectional communication
- LED status indication
- range of up to 450 m in the open field and up to 40 m indoors

Equipped	yes
Material	PA6
Mounting holes	2

PXF2M0017

About Us

Pushbuttons/Switches

Panel Mount Jacks

Emergency-Stop Buttons

Bus Technology

RFID

Enclosures

Pedal Switches

Terminal Blocks

Type Index

Equipped insulated plastic enclosures with sWave® radio technology

Emergency-stop with 2 NC contacts (conventionally wired), pushbutton, selector/key switch with NO contacts.

sWave®

Illustration Dimensions Description Type

IP65

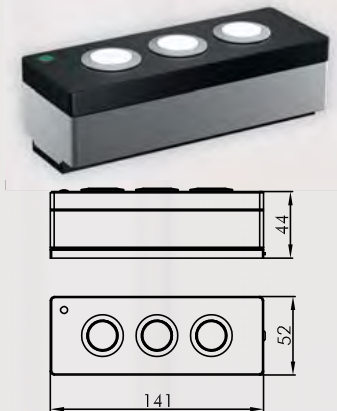

**Enclosure with radio technology
3 pushbuttons**

- equipped with 3 pushbuttons ST (without nameplates, with white non-transparent lenses)
- sWave® radio technology
- frequency 868.3 MHz (EU, China)
- long-life battery + performance monitoring
- bidirectional communication
- LED status indication
- range of up to 450 m in the open field and up to 40 m indoors

Equipped yes
Material PA6
Mounting holes 3

PXF3M0018

IP65

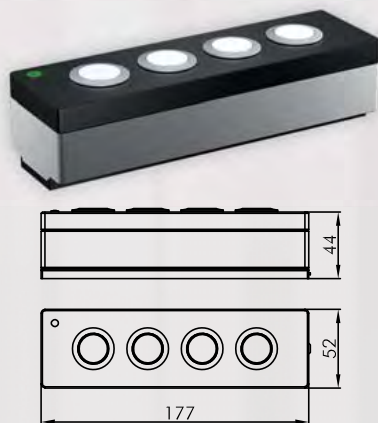

**Enclosure with radio technology
4 pushbuttons**

- equipped with 4 pushbuttons ST (without nameplates, with white non-transparent lenses)
- sWave® radio technology
- frequency 868.3 MHz (EU, China)
- long-life battery + performance monitoring
- bidirectional communication
- LED status indication
- range of up to 450 m in the open field and up to 40 m indoors

Equipped yes
Material PA6
Mounting holes 4

PXF4M0019

IP20



Radio receiver

- sWave® radio technology
- frequency 868.3 MHz (EU, China)
- 4 radio channels
- 4 NO, max. 3 A
- Ui 250 VAC
- operating voltage 24 VDC
- potential-free relay outputs
- LED status indication
- programming mode: up to 40 transmitter units (pushbuttons, switches) possible per receiver
- for fitting on top-hat rail
- range of up to 450 m in the open field and up to 40 m indoors

PXFE868

**customised configuration of the proboxx
under proboxx.schlegel.biz**

Accessories

Illustration





Dimensions

Description

Type

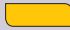

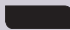



Flat lens, non-transparent

Colour	blue	 T22RRGBL
	yellow	 T22RRGGB
	green	 T22RRGGN
	black	 T22RRGSW
	red	 T22RRGRT
	white	 T22RRGWS

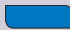

Flat lens, transparent

Colour	blue	 T22RRBL
	yellow	 T22RRGB
	green	 T22RRGN
	clear	 T22RRKL
	red	 T22RRRT



Blank nameplate

BSRRU



Nameplate with standard imprint

please specify index number (see nameplates in the product catalogue)

BSRR...



Mounting bracket for enclosures with 1 pushbutton or switch

for fixing the proboxx on a wall or on a profile
Material plastic

PXH1



Mounting bracket for enclosures with 2 pushbuttons or switches

for fixing the proboxx on a wall or on a profile
Material plastic

PXH2

About Us

Pushbuttons/Switches

Panel Mount Jacks

Emergency/Stop Buttons

Bus Technology

RFID

Enclosures

Pedal Switches

Terminal Blocks

Type Index

Accessories

Illustration

Dimensions

Description

Type



Mounting bracket for enclosures with 3 pushbuttons or switches

for fixing the proboxx on a wall or on a profile
Material plastic

PXH3



Mounting bracket for enclosures with 4 pushbuttons or switches

for fixing the proboxx on a wall or on a profile
Material plastic

PXH4

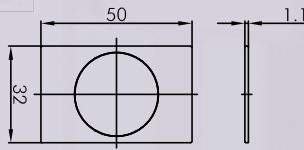

Marking tag

for labelling pushbuttons and switches of proboxx enclosure series
- easy to mount, clip-on type
- with or without laser inscription (text as per customer's specification)

Material PA6

Colour black

PXABT

IP65
IP67



Closing cap

screwable cap for unused M12 connection
Material PA6

PXSKM



About Us

Pushbuttons/Switches

Panel Mount Jacks

Emergency-Stop Buttons

Bus Technology

RFID

→ Enclosures

Pedal Switches

Terminal Blocks

Type Index



Georg Schlegel GmbH & Co. KG
Kapellenweg 4
88525 Dürmentingen / Germany

☎ +49 (0)7371 / 502-0
📠 +49 (0)7371 / 502 49
@ info@schlegel.biz
www.schlegel.biz



Subsidiaries:

Schlegel Elektrokontakt GmbH
Schönbachstr. 93
04299 Leipzig / **Germany**

Tel.: +49 (0)341 / 8 68 72-0
Fax: +49 (0)341 / 8 68 72 43
E-Mail: leipzig@schlegel.biz
www.schlegel.biz

Georg Schlegel Vertriebs Ges.mbH
Samuel Morse-Straße 7
2700 Wiener Neustadt / **Austria**

Tel.: +43 (0)2622 / 8 13 13
Fax: +43 (0)2622 / 8 13 13-19
E-Mail: schlegel@schlegel.at
www.schlegel.at